

ARJAN

48 PARKSIDE

TABEER

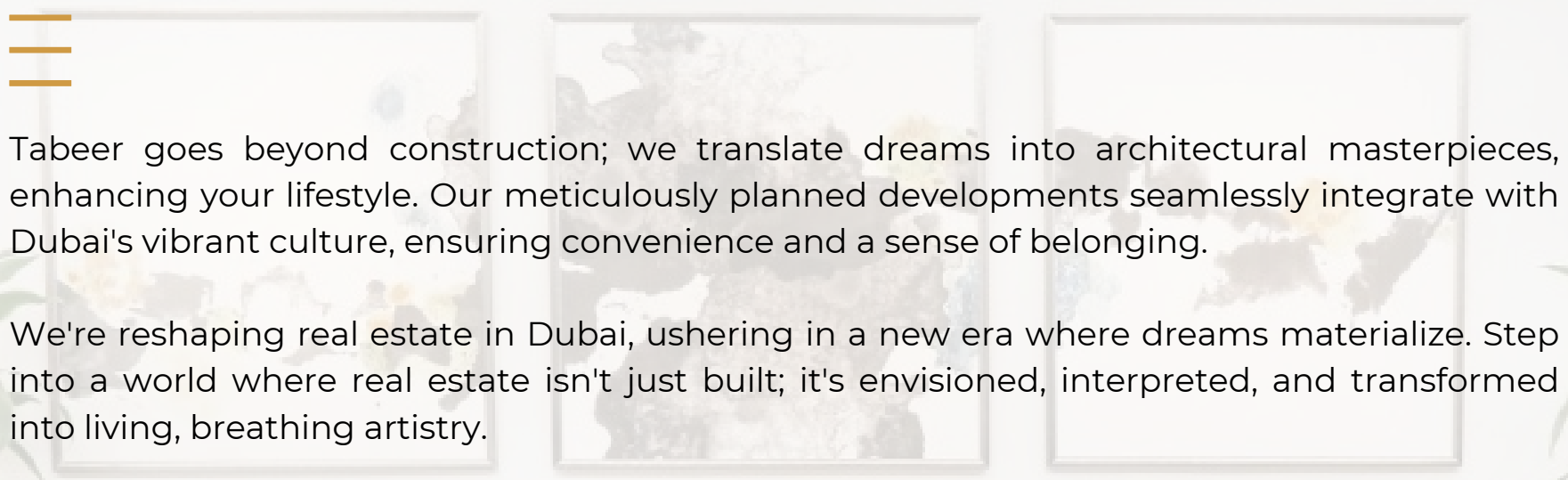

Tabeer goes beyond construction; we translate dreams into architectural masterpieces, enhancing your lifestyle. Our meticulously planned developments seamlessly integrate with Dubai's vibrant culture, ensuring convenience and a sense of belonging.

We're reshaping real estate in Dubai, ushering in a new era where dreams materialize. Step into a world where real estate isn't just built; it's envisioned, interpreted, and transformed into living, breathing artistry.

Join us on this journey where your aspirations find expression, and your accomplishments become enduring symbols of success.

VISION

Tabeer Development aspires to revolutionize the concept of luxurious living, setting the gold standard for opulent, eco-conscious, and forward-thinking lifestyles. Our mission is to create enduring masterpieces that embody our unwavering dedication to unparalleled excellence in the realm of upscale living.

MISSION

Our mission is to create exceptional living spaces that exceed client expectations, driven by architectural excellence, sustainability, and unmatched customer satisfaction, setting new standards in luxury real estate development.



DUBAI

Step into the future with a home in Dubai, the pinnacle of innovation and luxury. As we forge ahead in the golden era of real estate, we invite you to experience life at the zenith of sophistication, surrounded by iconic skyscrapers and unparalleled amenities. Our developments, a seamless blend of tradition and modernity, stand as beacons of architectural excellence and comfort.



ARJAN

Arjan in Al Barsha South is an emerging, diverse neighborhood boasts with residences and businesses, alike. Notably, it features the iconic Dubai Miracle Garden, a vibrant landmark. The neighborhood hosts prestigious international schools like Safa Community School and King's School. Alongside, it offers reputable medical facilities, including Mediclinic Parkview Hospital, ensuring healthcare accessibility for residents and establishing Arjan as an attractive and balanced urban living destination.





LUXURY MEETS AFFORDABILITY

Mediclinic
Parkview Hospital
مستشفى بارك فيو

Safa Community School

Dubai Butterfly Garden
حديقة الفراشات

Dubai Miracle
Garden
حديقة دبي
المعجزة

ARJAN-DUBAILAND
أرجان دبي لاند

Dubai Hills
Mall
7 MINS

Mall of the
Emirates
10 MINS

Dubai
Miracle
Garden
2 MINS

Mediclinic
Parkview
Hospital
2 MINS

Global
Village
Street 54
7 MINS

Downtown
Dubai
20 MINS



The Oasis |
Arabian Ranches

Raffles Early Childhood
Centre Arabian Ranches
مركز رافلز
للطفولة المبكرة...

Prime Medical
Center - Motor City
برايم ميديكال
موتور سيتي



48 Parkside in Arjan (Al Barsha South), Dubai, offers upscale apartments with unmatched amenities, blending luxury and comfort. Residents can relish in a rooftop garden, business center, 24/7 security, and views of a lush adjacent park.

With facilities ranging from a state-of-the-art wellness center semi-olympic size to infinity pools and a kids' pool, it epitomizes the pinnacle of modern luxury living.



LEISURE & SKY DECK



Green Area



Kids Pool



Mini Golf

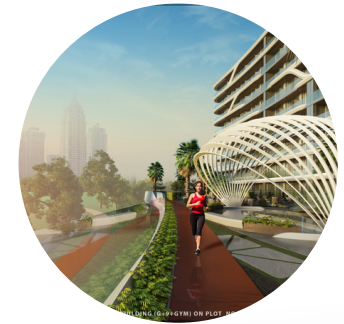

Jogging Track



Semi Olypmic Size Inifinty Pool



BBQ Area



Rooftop Sitting Area



Wellness Centre



LEISURE DECK
OVER 30,000 SQ. FT OF AMENITIES



ABEER

GREEN AREA

This offers a dedicated BBQ area and cozy seating for residents to enjoy the lush green surroundings.



BBQ AREA

Gather with friends and family for delightful outdoor grilling experiences at the dedicated BBQ area.



KIDS POOL AREA

Families will appreciate the dedicated kids' pool area, ensuring safe and enjoyable water fun for children.



MINI GOLF CLUB

The 400m mini-golf course on the premises is a unique addition, offering an engaging recreational option that promotes community interaction and fun for sports enthusiasts and leisure seekers alike.



TABE

An architectural rendering of a modern rooftop terrace. A woman in a red tank top and black leggings is jogging on a reddish-brown track. To her right is a large, white, curved structure made of many thin, parallel ribs, resembling a modern sculpture or a canopy. In the background, there are palm trees, a swimming pool area with lounge chairs, and a city skyline under a clear blue sky.

JOGGING TRACK

Stay active and maintain a healthy lifestyle with a 750m jogging track, allowing for invigorating runs and walks.



SKY DECK
OVER 30,000 SQ. FT OF AMENITIES



INFINITY POOL

The Semi-Olympic sized infinity pool at 48 Parkside offers a luxurious escape with breathtaking views, making it an ideal spot for relaxation along with leisurely swims.



TABEER



ROOFTOP SITTING AREA

Enjoy the Dubai skyline from the rooftop sitting area, a perfect place for unwinding and socializing.



JUST
DO
IT

WELLNESS CENTRE

Stay fit and active at the state-of-the-art, well-equipped wellness centre, ensuring residents have easy access to their fitness needs.



Residents have a dedicated space for their fitness and health pursuits, making it an integral part of everyday life within our community.

The image is a digital architectural rendering of a wellness center. It features a long, curved walkway paved with dark, square tiles. To the left, a glass-enclosed gym is visible, containing treadmills and other exercise equipment. To the right, a long, low water wall cascades down, creating a series of small, rhythmic waterfalls. The building's design is modern and minimalist, with clean lines and a neutral color palette. The sky is a clear, light blue, suggesting a bright, sunny day. The overall atmosphere is one of tranquility and modern luxury.

With an expansive 30,000 square feet at our disposal for amenities, we've crafted a wellness center that goes beyond the ordinary. It's a space where residents can explore diverse fitness options, indulge in relaxation, and prioritize their well-being, all within the embrace of our vast, wellness-focused community.

We place fitness and well-being at the forefront, ensuring that residents have the resources to lead a vibrant and balanced lifestyle. Our commitment to health is woven into the very fabric of our community, promoting a culture of well-being that residents can embrace wholeheartedly.







Elevate your well-being at 48 Parkside, where fitness and health are not just an afterthought but a fundamental aspect of our community. Our cutting-edge wellness center serves as a hub for residents to nurture their physical and mental health, emphasizing the importance of holistic well-being in everyday life.



LOBBY



Step into the exquisitely crafted, opulent lobby of 48 Parkside, where luxury meets grandeur.





LOBBY

This meticulously designed entrance sets the tone for the entire experience, inviting residents and guests into a world of unparalleled sophistication and comfort.



LOBBY

The grand lobby at 48 Parkside is graced by a stunningly grand chandelier and boasts three spacious elevators, combining luxury and practicality in one breathtaking space.





INTERIORS



Our bedrooms are sanctuaries of tranquility and luxury. Every detail, from the softest linens to the carefully designed layouts, is crafted to provide a restful retreat.

Spacious and elegantly appointed, our bedrooms offer a harmonious blend of comfort and style. Wake up to breathtaking views and enjoy a sense of serenity that only Tabeer can deliver.



KITCHEN

Experience culinary bliss in a Spanish Kitchen, complete with fully fitted kitchen and European accessories (white goods).



LIVING ROOM

Introducing a first-of-its-kind, 1x3 Turkish Kale tiles to enhance indoor spaces with refinement. Our living rooms feature modern home automation systems and luxurious suspended ceilings for an elegant living experience.



BATHROOM

The bathroom is entirely Spanish in design, featuring first-of-its-kind, 1x3 Turkish Kale tiles that extend from the floor to the ceiling. The fixtures and fittings in the bathroom have been carefully selected from IW&W Spain, incorporating a hint of luxurious gold accents.



BEDROOM

Showcasing impeccable finishing. These spacious sanctuaries provide grandeur and ultimate comfort, epitomizing luxurious relaxation with attention to every detail.





WARDROBE

A comprehensive closet spanning from one end of the wall to the other, complete with interior lighting and an integrated smart system.



EXTERIOR



48 Parkside offers serene community park and Leisure Deck views, complemented by private plunge pools for your enjoyment.





48 PARKSIDE

CONCIERGE & 24/7 SECURITY

48 Parkside promises unmatched luxury living with attentive concierge service and a 24/7 robust security system, ensuring effortless comfort and unwavering safety for residents.



Among our offerings, you'll find a peaceful plunge pool, creating a tranquil oasis where residents can relax and rejuvenate in a stylish setting.







APARTMENT LAYOUTS





FLOOR PLANS - TYPES OF APARTMENTS

1 BHK

SUITE 201

 STUDY

 LEISURE DECK FACING

TOTAL AREA : 833 Sq.ft

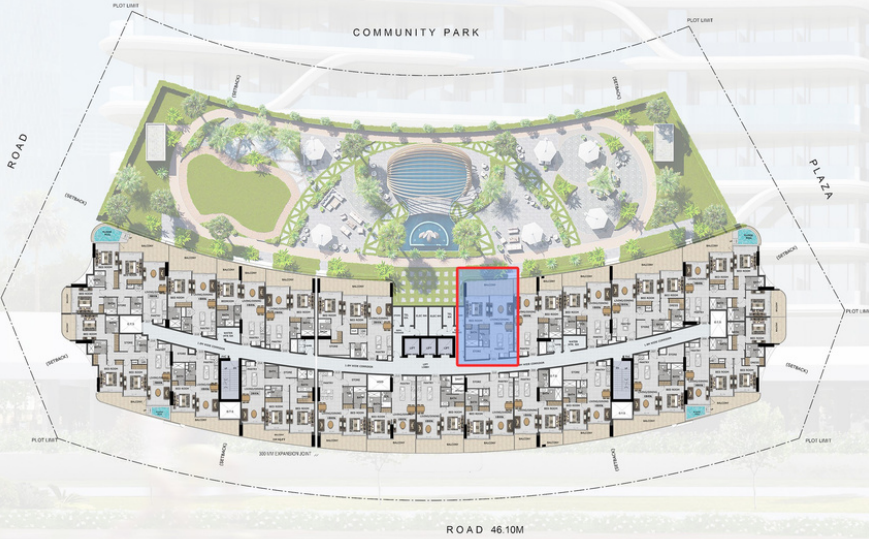

ROAD 46.10M

KEY PLAN



— — —
1 BHK
— — —
SUITE 202

 LEISURE DECK FACING

TOTAL AREA : 744 Sq.ft

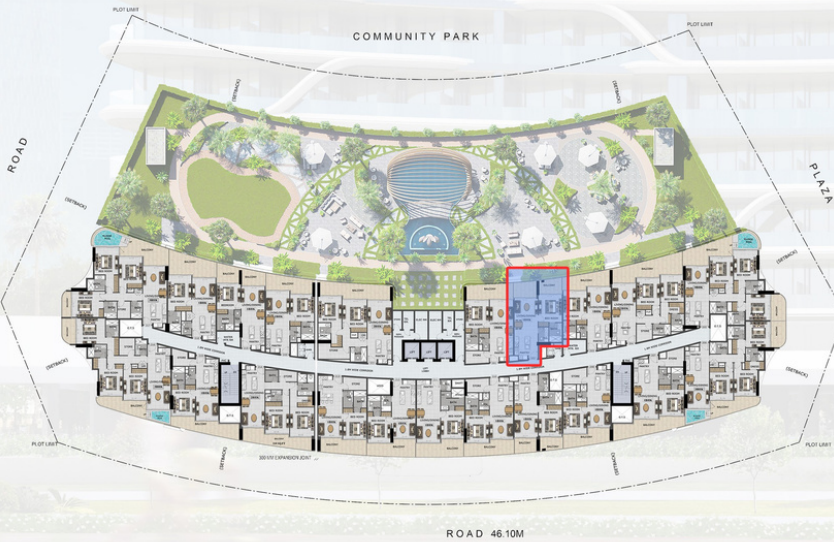

KEY PLAN



2 BHK

SUITE 204

 STUDY

 LEISURE DECK FACING

TOTAL AREA : 1233 Sq.ft



COMMUNITY PARK

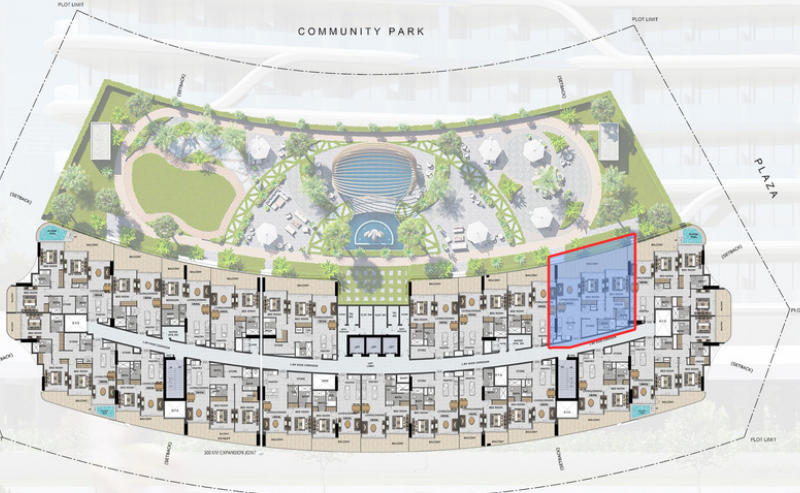

ROAD 46.10M

KEY PLAN



3 BHK

SUITE 205



LAUNDRY



PLUNGE POOL



LEISURE DECK FACING

TOTAL AREA : 1508 Sq.ft

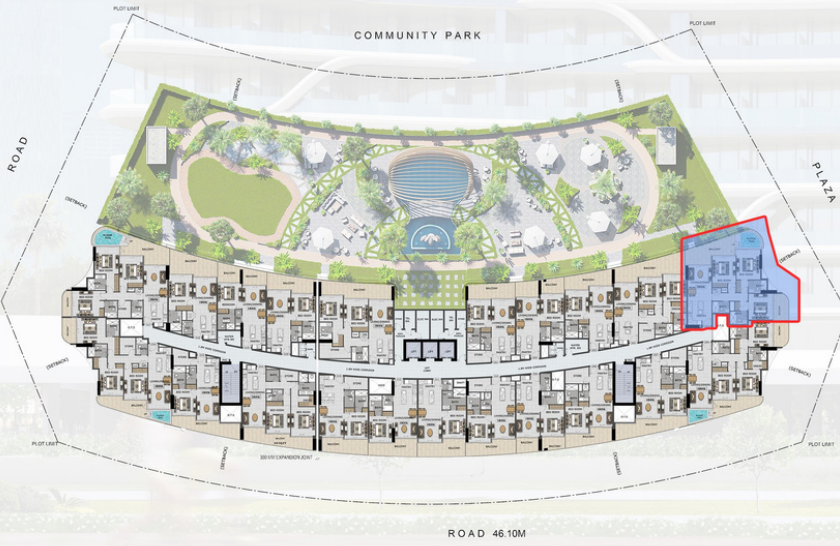

KEY PLAN



3 BHK

SUITE 216



LAUNDRY



PLUNGE POOL



STUDY

TOTAL AREA : 1522 Sq.ft

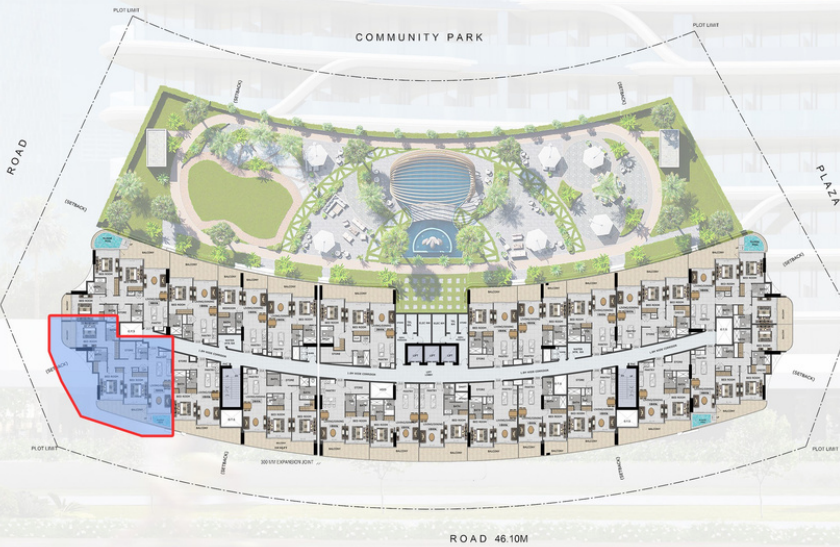

KEY PLAN



Mediclinic
Parkview Hospital
مستشفى بارك فيو

Safa Community School

Dubai Butterfly Garden
حديقة الفراشات

Dubai Miracle
Garden
حديقة دبي
المعجزة

The Oasis |
Arabian Ranches

Raffles Early Childhood
Centre Arabian Ranches
مركز رافلز
للطفولة المبكرة...



Street-54

Street-54

30

28

E311

E311



OFFICE 201 - FIDARJAN BUILDING, ARJAN, DUBAI

+971 4 3350034

INFO@TABEERPROPERTIES.COM

WWW.TABEER.AE



FACEBOOK



INSTAGRAM